

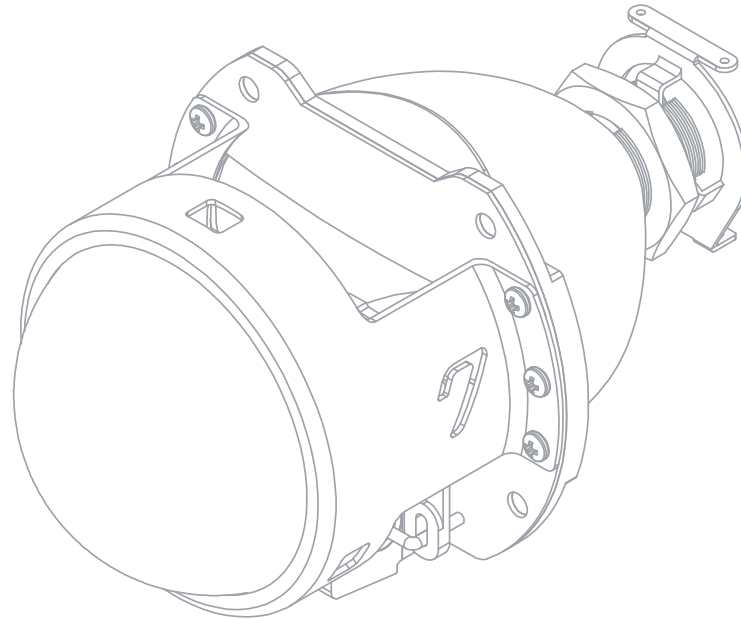

THE AUTOMOTIVE LIGHTING BENCHMARK



INSTALLATION GUIDE

MINI H1 7.0 STAGE III KIT



WARNING: By reading this document, I agree it is only to be used as an educational guide. Morimoto Lighting makes no guarantee on any finished results, nor are they to be held responsible for any damage, misuse, or personal injuries. Use at your own risk. If you are unable to clearly understand and adapt the information below to your own application, professional installation is recommended.

TABLE OF CONTENTS

SYSTEM DIAGRAM (CHOOSE YOURS)	P.3
EXTERNALLY-WIRED W/ CANBUS	P.4
EXTERNALLY-WIRED W/ HD RELAY	P.5
INTERNALLY-WIRED W/ CANBUS	P.6
INTERNALLY-WIRED W/ HD RELAY	P.7
DUAL FILAMENT W/ MOTOCONTROL	P.8
DUAL FILAMENT W/ CANBUS	P.9
HARNESS INSTALLATION	P.10
PROJECTOR INSTALLATION	P.10
HARDWARE CONTENTS	P.11
HARDWARE SCHEMATIC	P.11
BULB INSTALLATION	P.11
EXTERNALLY-WIRED INSTALL	P.12
INTERNALLY-WIRED INSTALL	P.12
BALLAST INSTALLATION	P.13
HALO INSTALLATION	P.14
SHROUD INSTALLATION	P.15
USING RETRORUBBER SEALANT	P.15

STANDARD PARTS

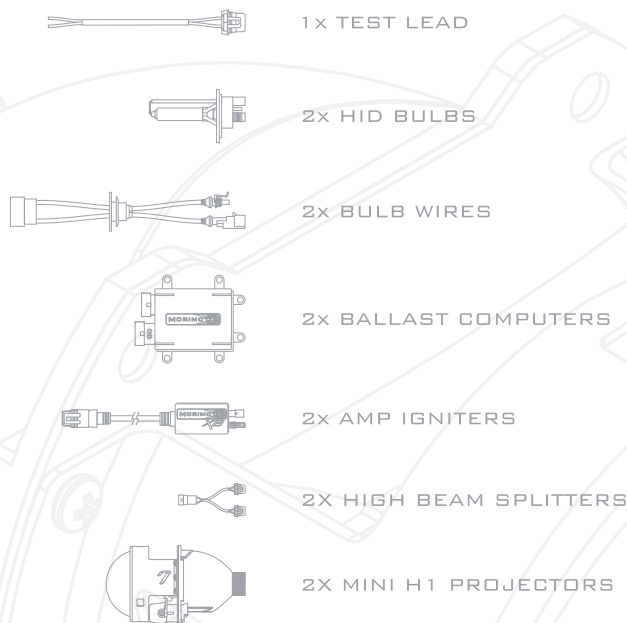

OPTIONAL PARTS



SPECIAL NOTE:

The included ballast test lead is used for troubleshooting purposes only and is not part of the installation of this system. If necessary, the test lead can be plugged into the ballast input then connected to a 12V+ source to test the ballast. This must be done with the bulb connected to the ballast prior to applying power.





NOTE: System diagrams are to be used for reference purposes only. If you are unsure of the installation procedure for any individual part, review its install procedure prior to proceeding.

IDENTIFYING YOUR INSTALLATION TYPE



NOTE: There are three types of wiring installations with this system: EXTERNAL LOW-BEAM, INTERNAL LOW-BEAM, and DUAL FILAMENT. The installation guide that follows will cover all three types.

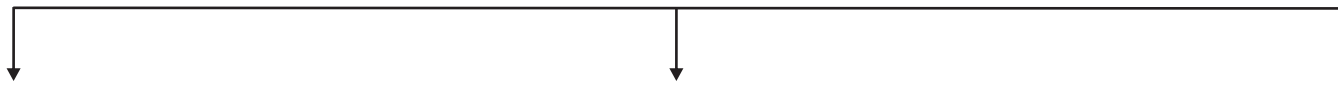

EXTERNAL LOW-BEAM

Separate low and high beam bulbs; When you can access the bulb from the back of the headlight without removing any caps or covers. Wiring for the bulb is visible and accessible outside of the housing.



PROCEED TO PAGE 4

INTERNAL LOW-BEAM

Separate low and high beam bulbs; When you must first remove a cap (generally plastic) to access the bulb. Inside the housing, there is wiring going to the bulb.



PROCEED TO PAGE 6

DUAL FILAMENT

Shared low/high beam bulb; You can access the bulb from the back of the headlight without removing any caps or covers. Wiring for the bulb is visible and accessible outside of the housing.



PROCEED TO PAGE 8

Right Side of Vehicle

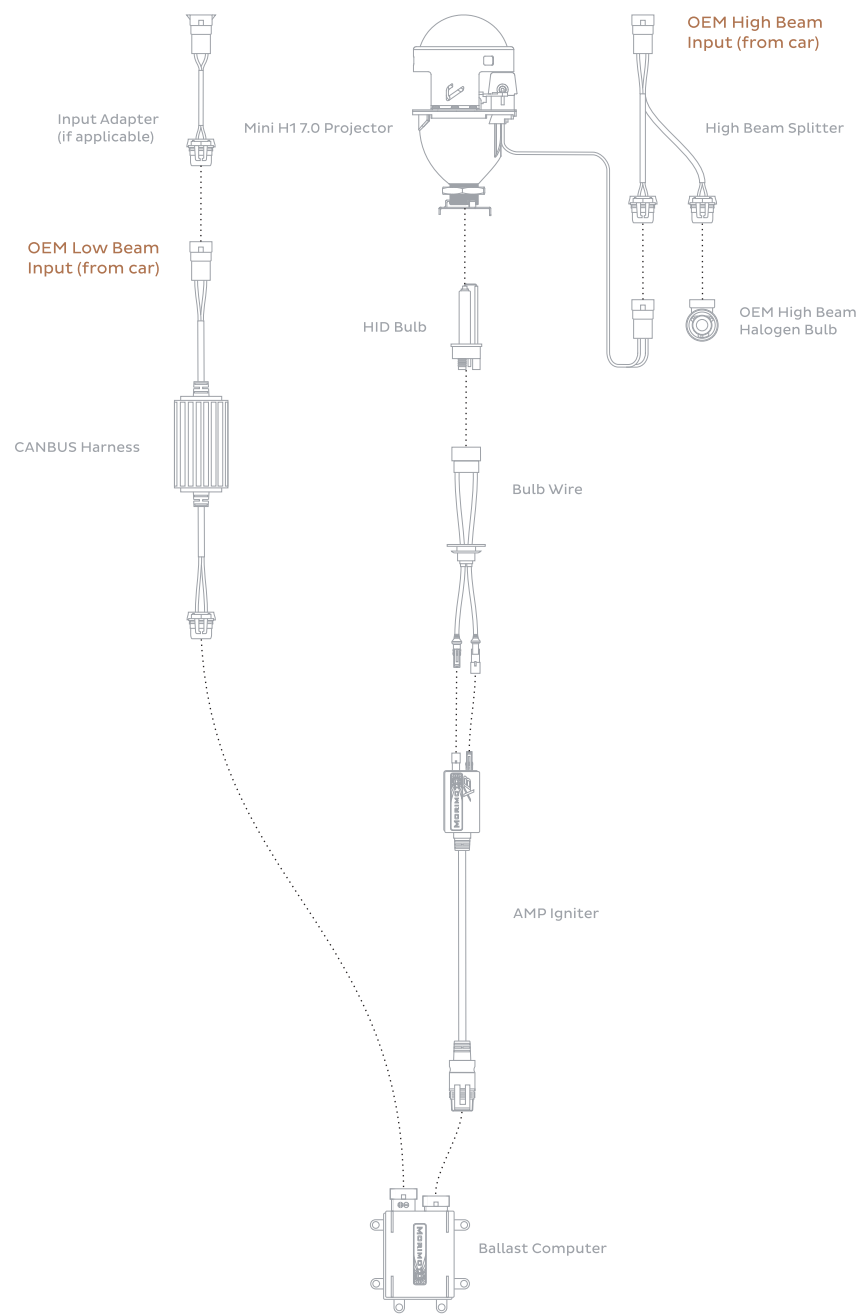

Left Side of Vehicle

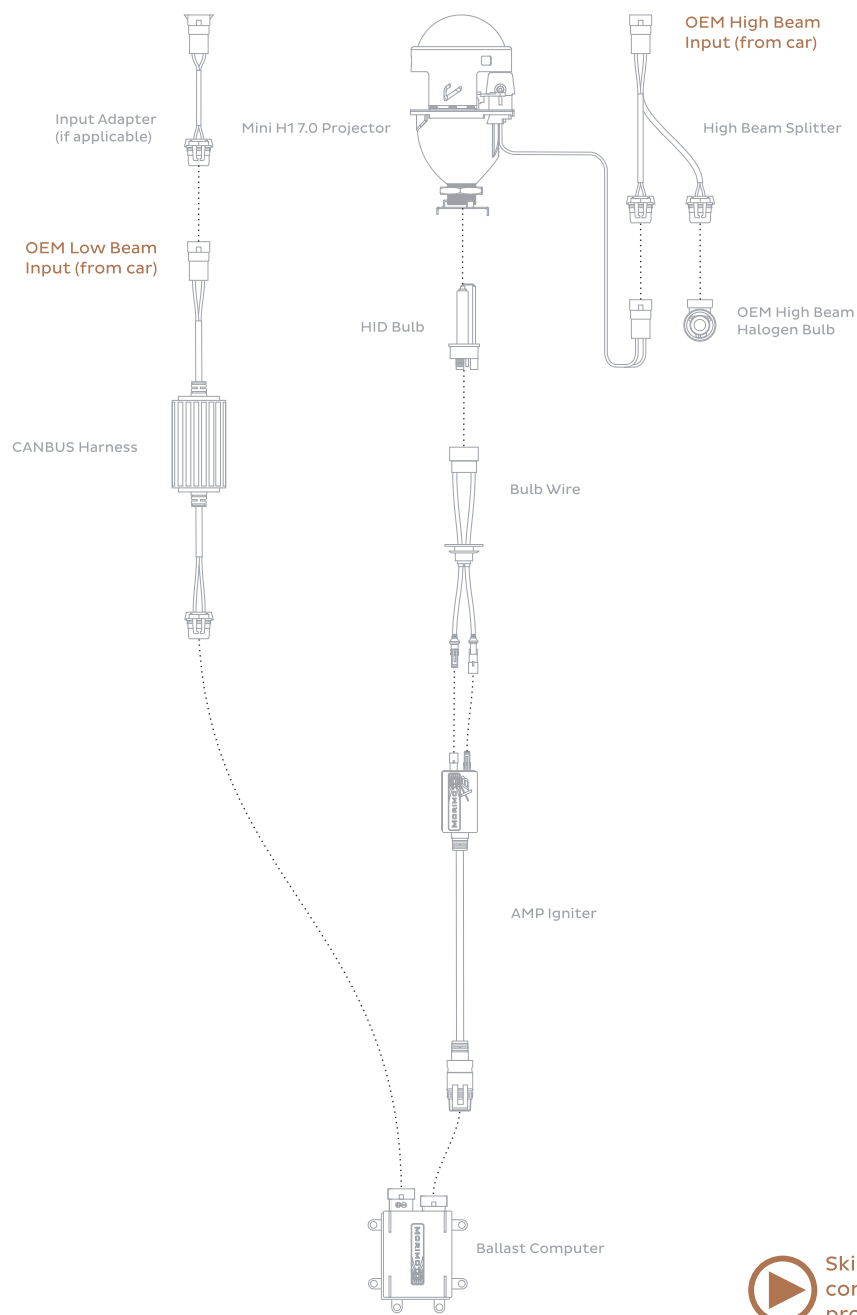

 Skip to Page 10 for component-specific procedures

EXTERNALLY-WIRED W/ HD RELAY HARNESS

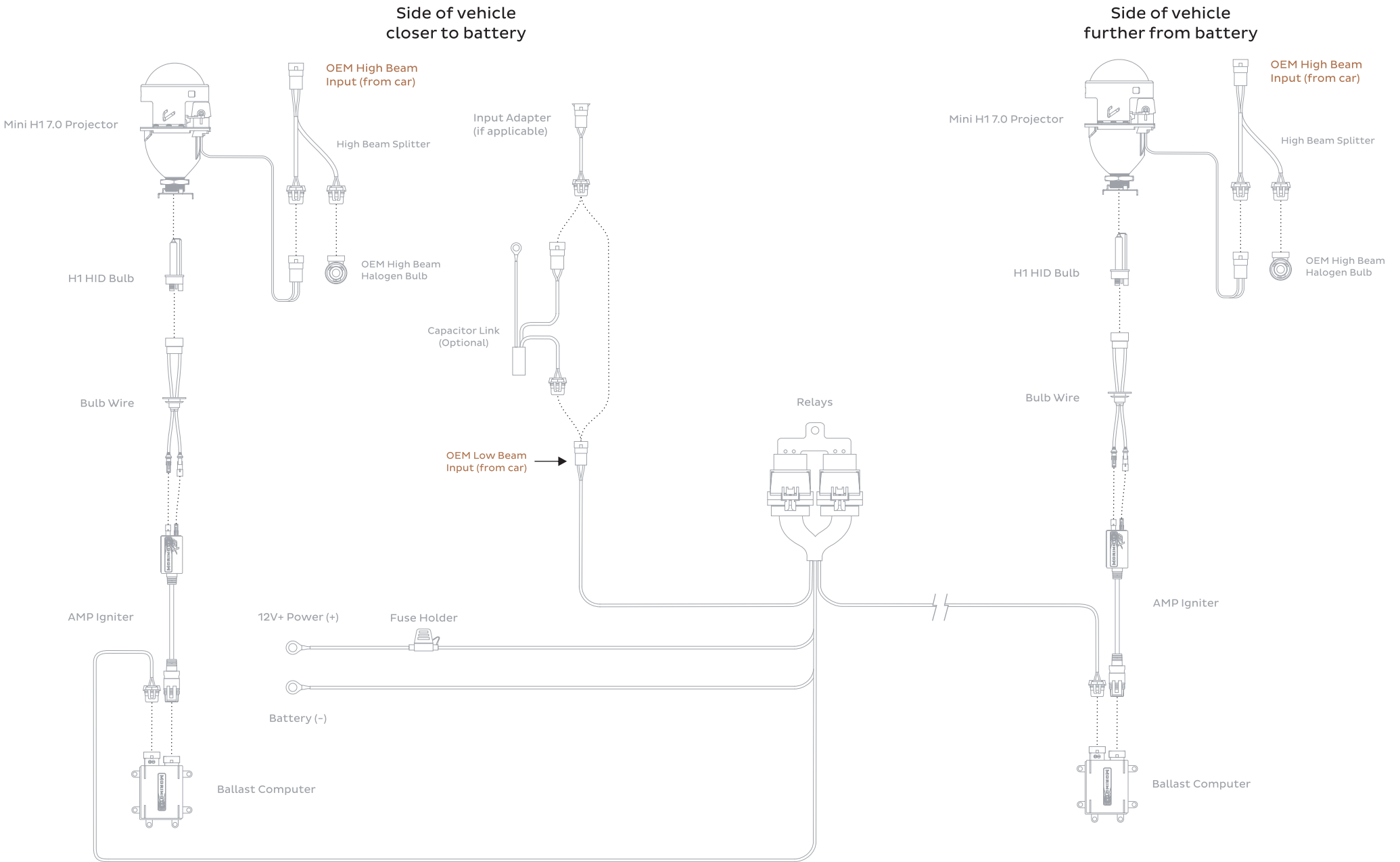

 Skip to Page 10 for component-specific procedures

Right Side of Vehicle

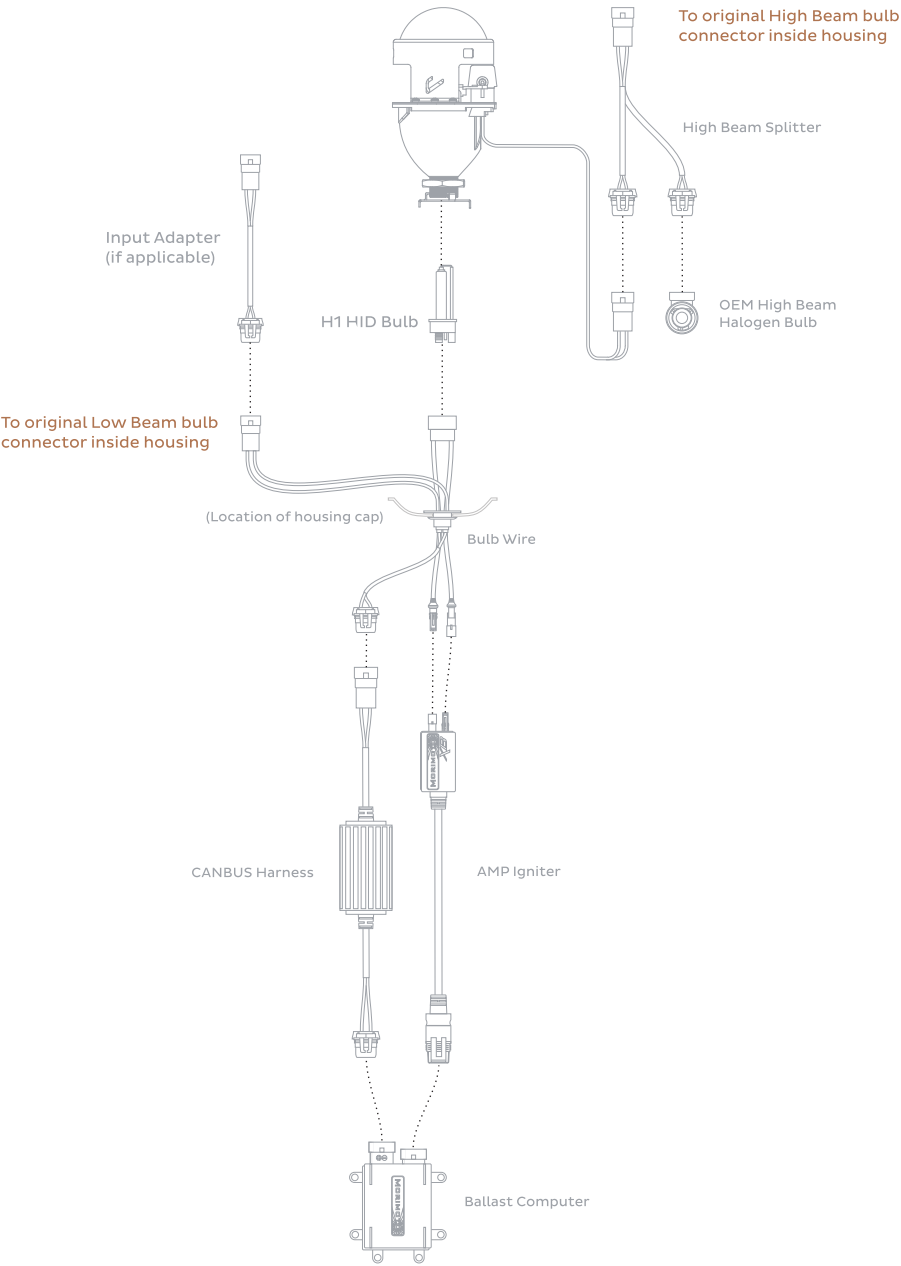

Left Side of Vehicle

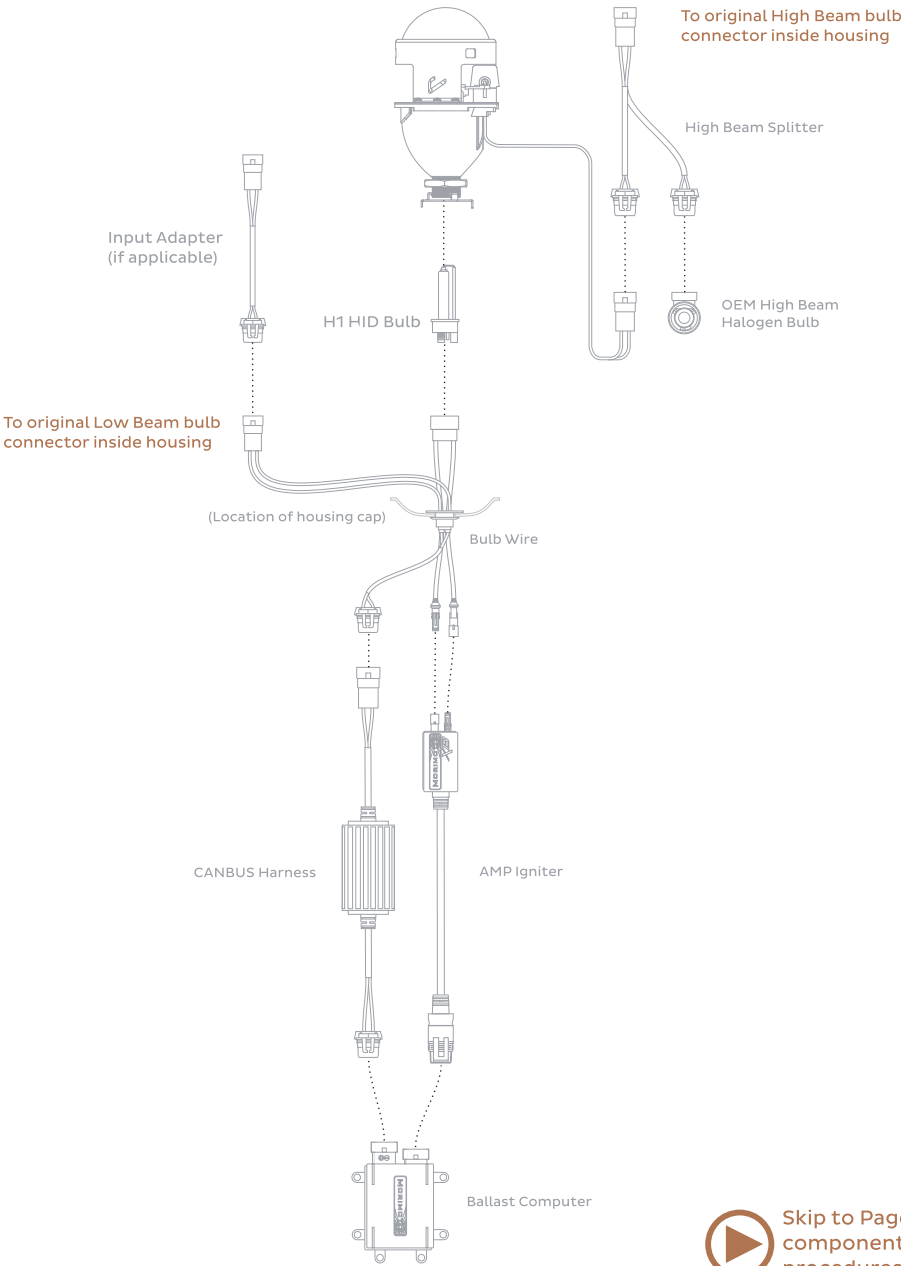

 Skip to Page 10 for component-specific procedures

INTERNALLY-WIRED W/ HD RELAY HARNESS

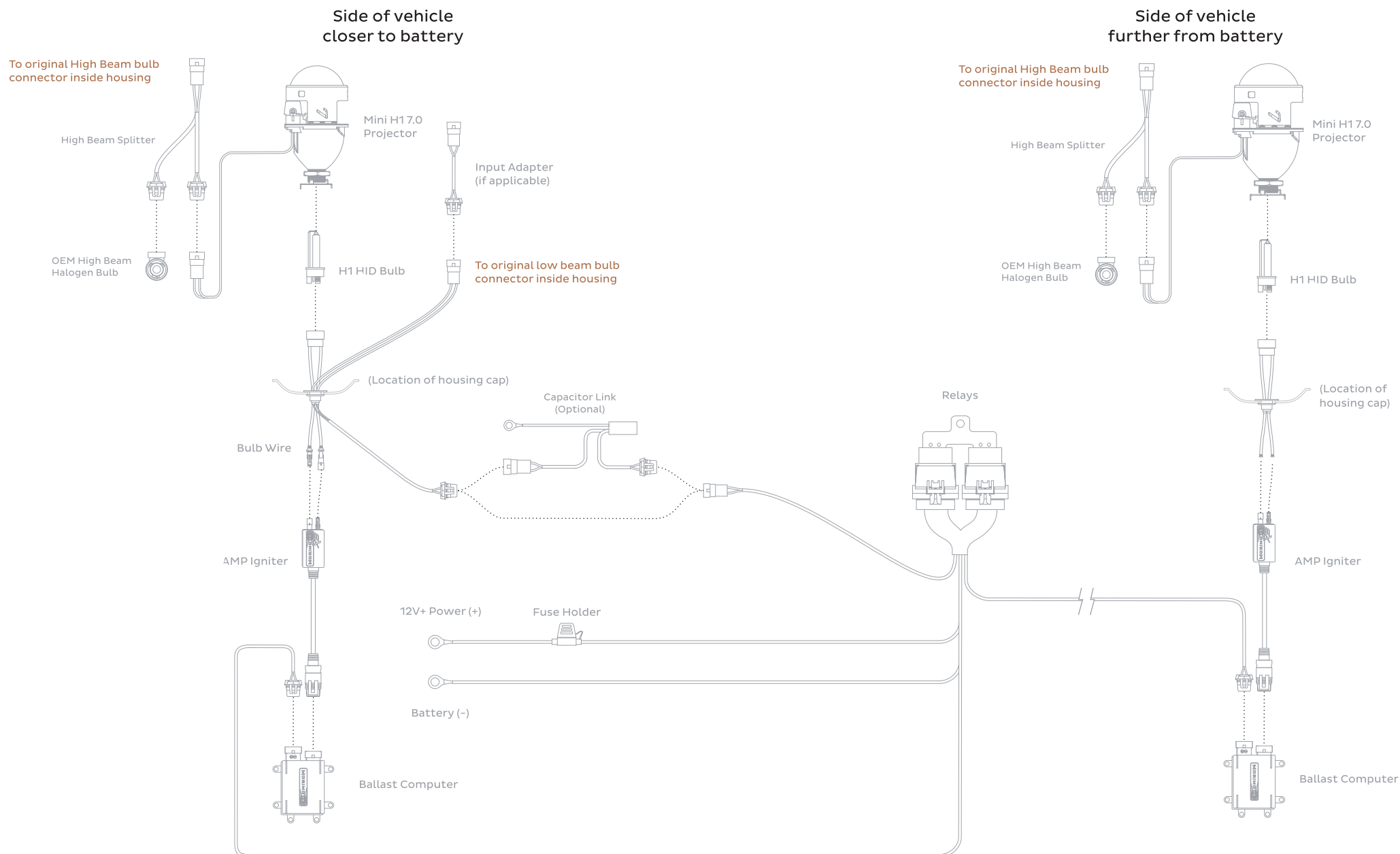

▶ Skip to Page 10 for component-specific procedures

DUAL FILAMENT WITH MOTOCONTROL HARNESS

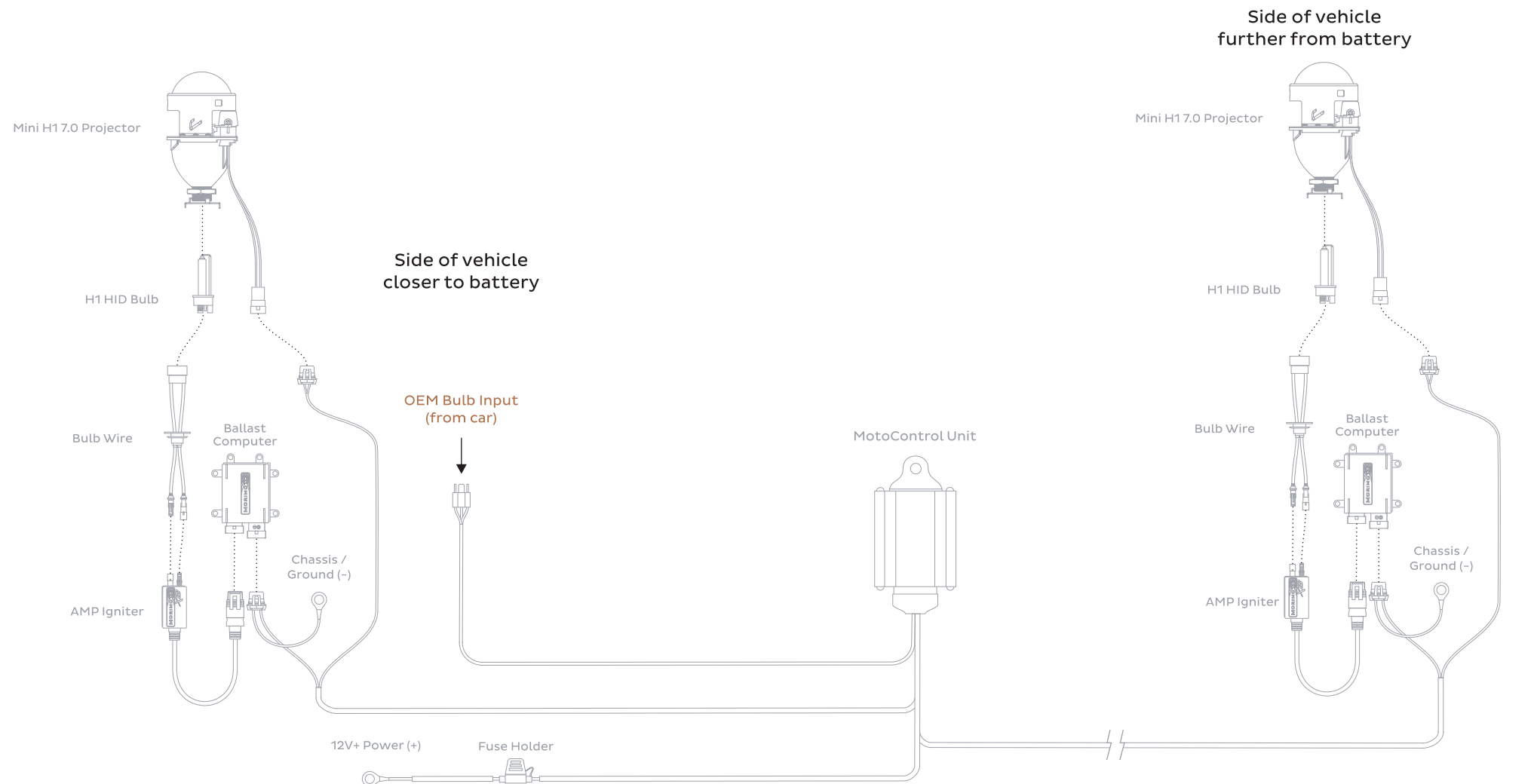

 Skip to Page 10 for component-specific procedures

Right Side of Vehicle

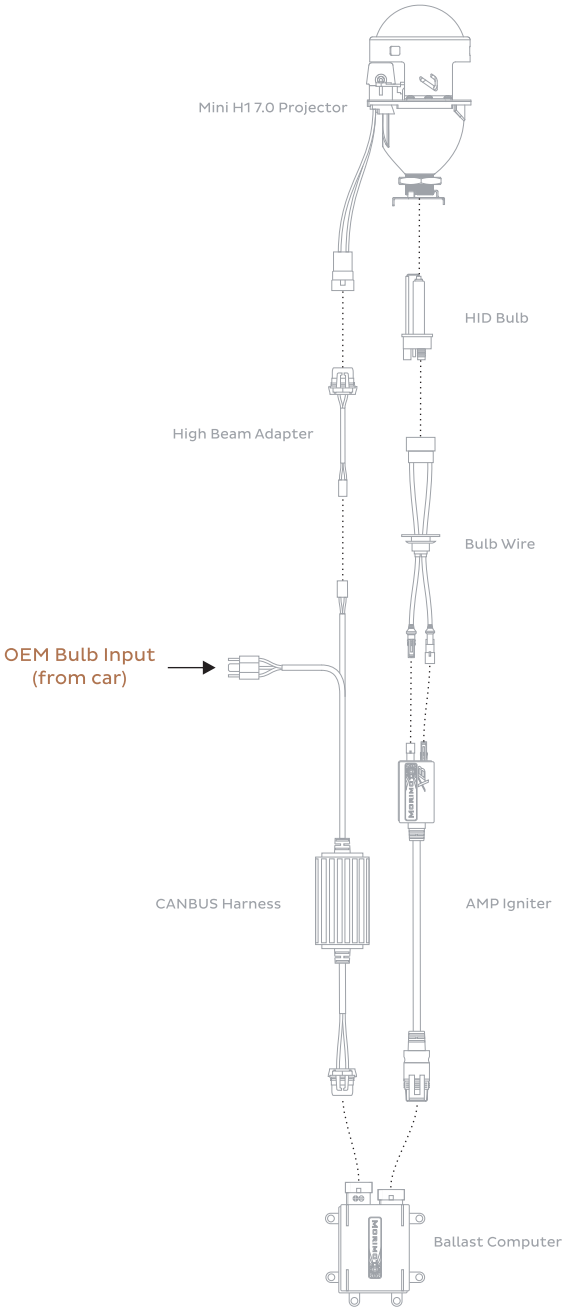

Left Side of Vehicle

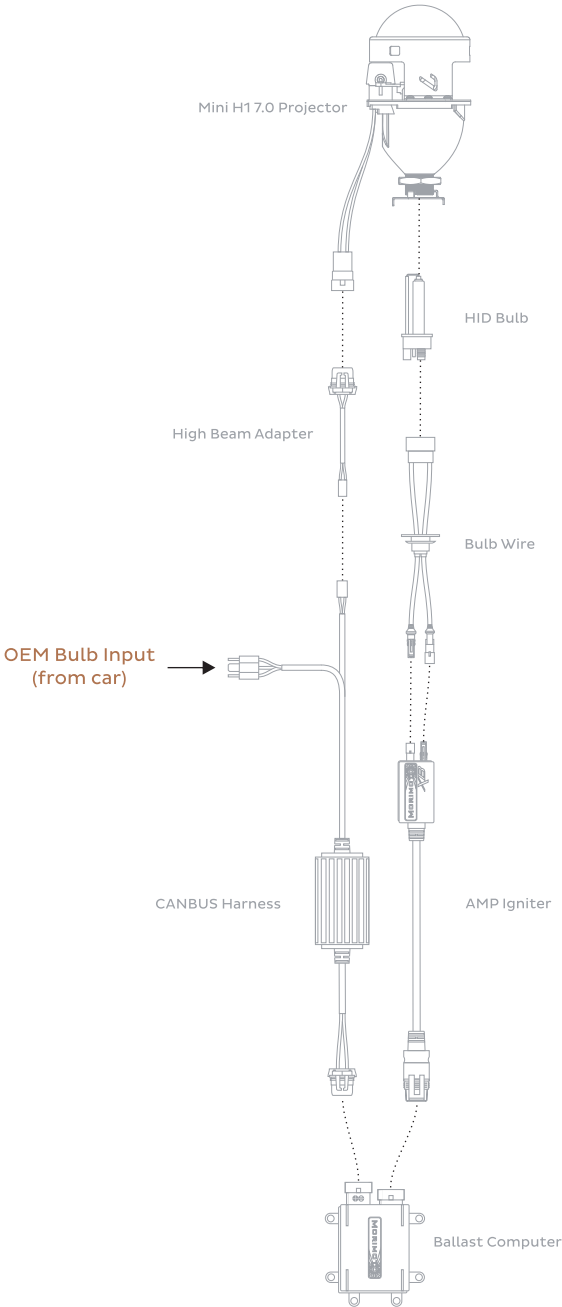

Skip to Page 10 for component-specific procedures

HARNESS INSTALLATION

SPECIAL NOTE: ALL HARNESSES

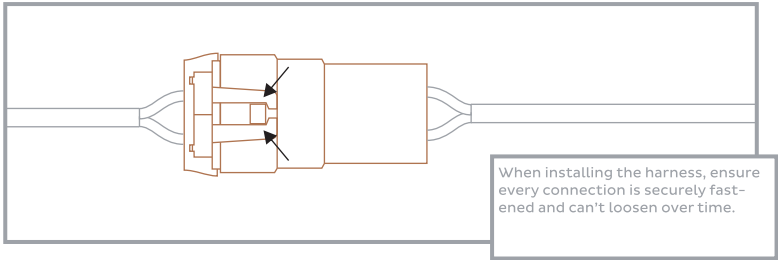

SPECIAL NOTE: HD RELAY AND MOTOCONTROL HARNESSES

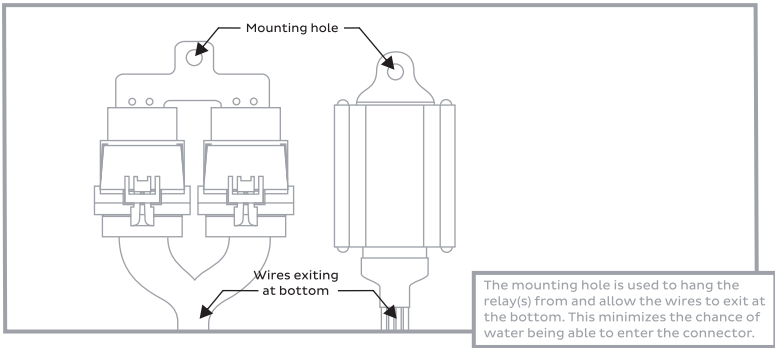

PROJECTOR INSTALLATION

HARDWARE CONTENTS



1x H4 Silicone Grommet



1x H7 Silicone Grommet



1x H4 Adapter Plate



1x H7 Adapter Plate



4x Mini Gatling Gun Screws



1x 9006 Male Connector



1x Bulb Retaining Clip



1x Hex Lock Nut



1x Three-Prong Bulb Holder



3x Bulb Holder Screws



2x 9006 Socket Grommets

SPECIAL INSTALLATION NOTE

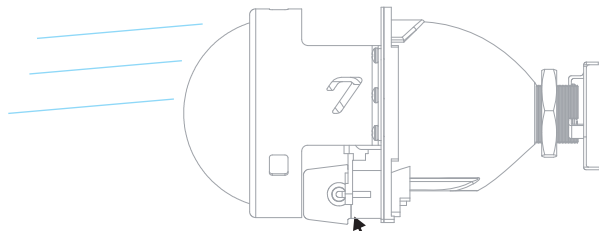

Mount projector rotationally level and with the solenoid and light cutoff shield on the bottom for proper light output

HARDWARE SCHEMATIC

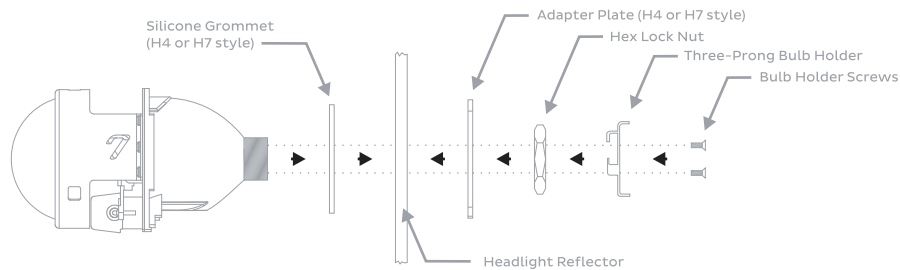

SOLENOID WIRING SCHEMATIC

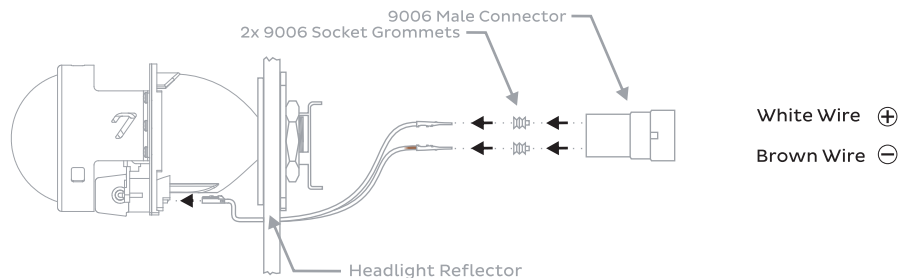

BULB INSTALLATION



CAUTION: HOT!



HANDLE ONLY WITH
BLACK PLASTIC BASE

STEP BY STEP

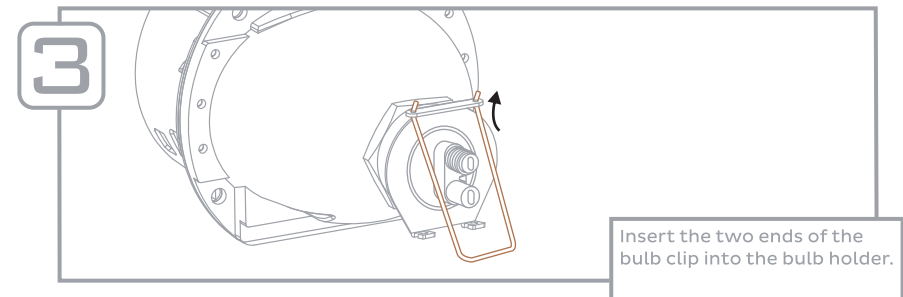
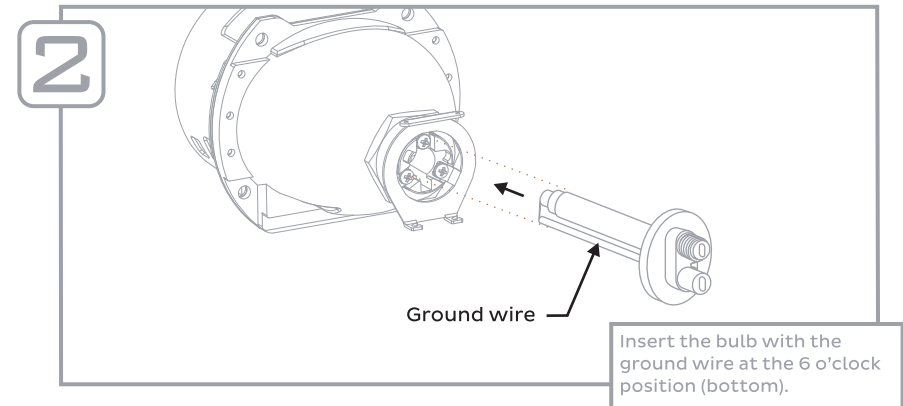
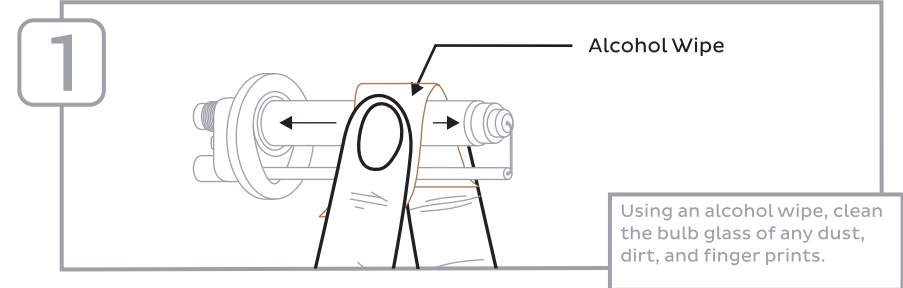

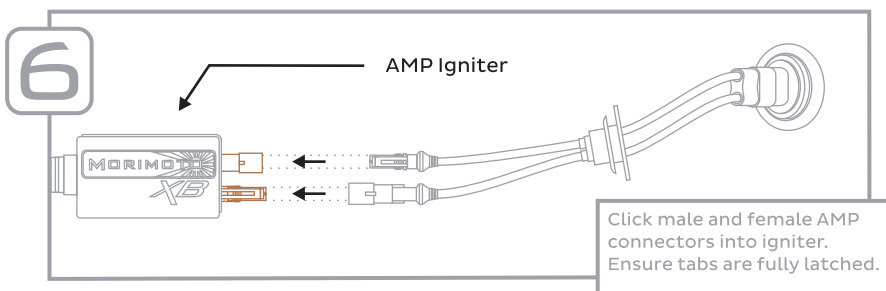
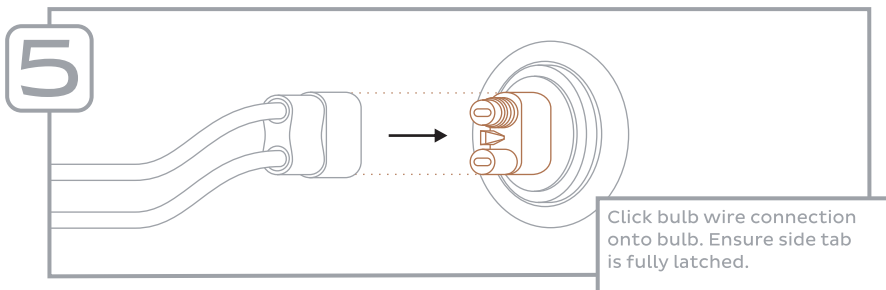
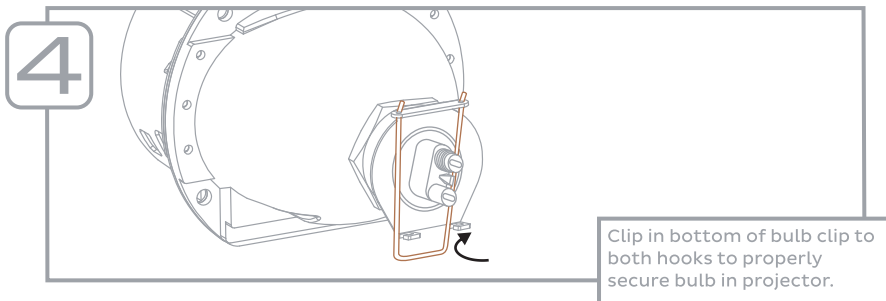

Proceed to either
INTERNALLY or **EXTERNALLY**
step #7

STEP BY STEP - EXTERNALLY-WIRED

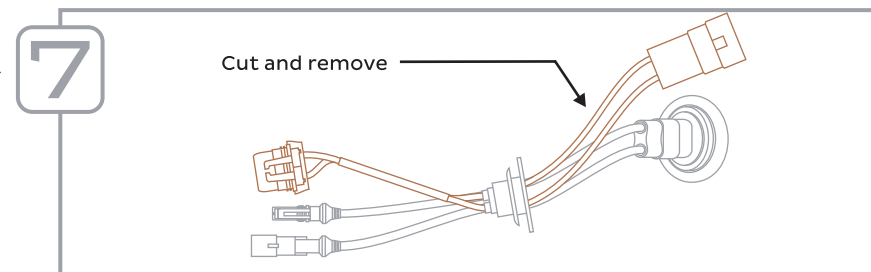

STEP BY STEP - INTERNALLY WIRED

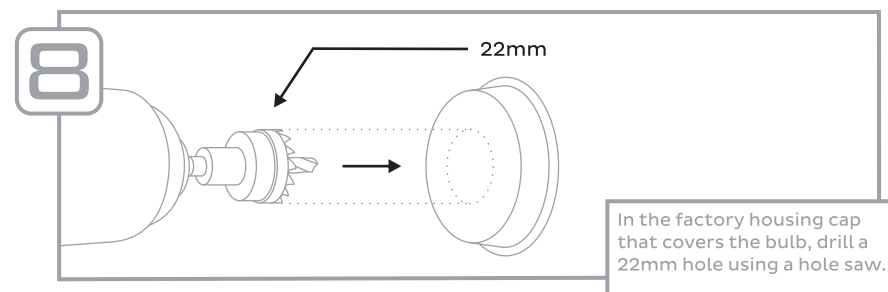
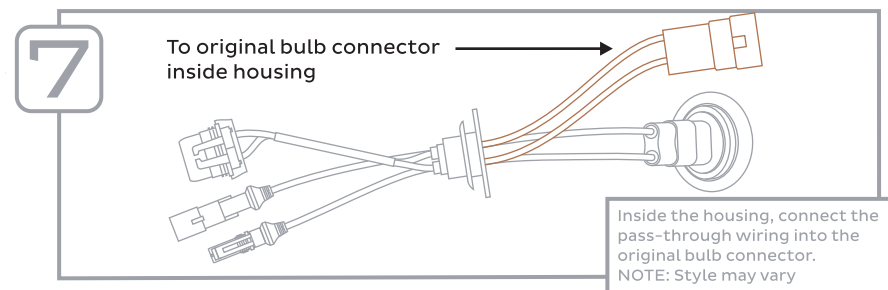

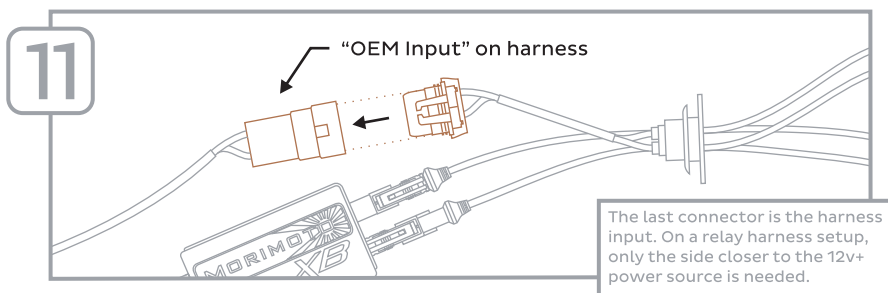
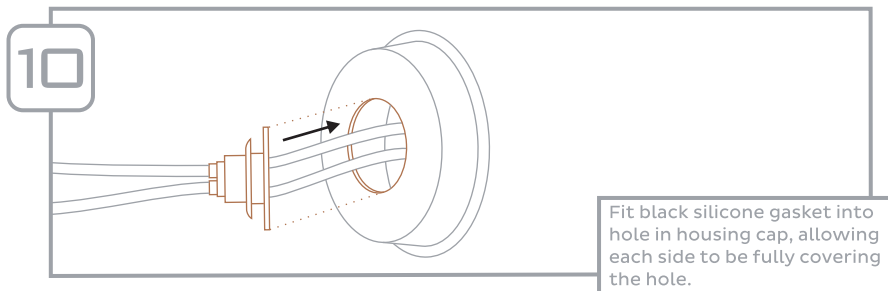
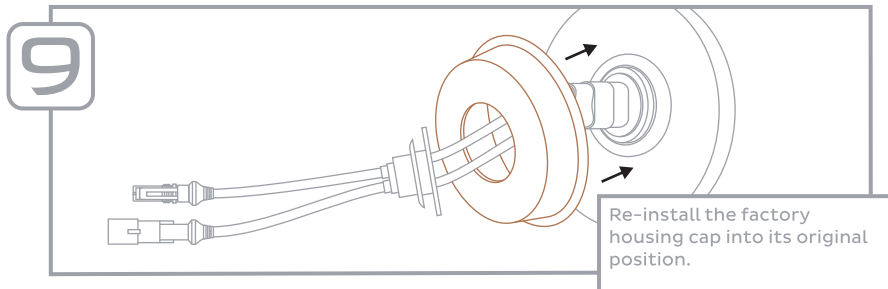

BALLAST INSTALLATION



DO NOT IGNITE UNTIL
FULLY CONNECTED!



WATERPROOF

SCHEMATIC

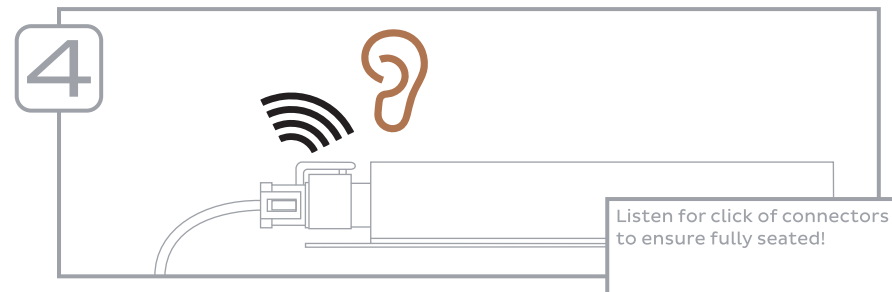
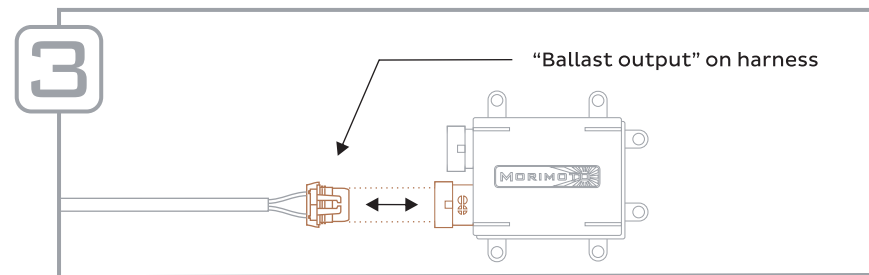
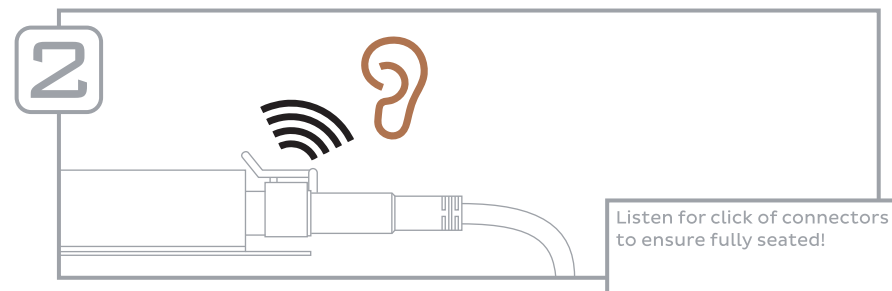
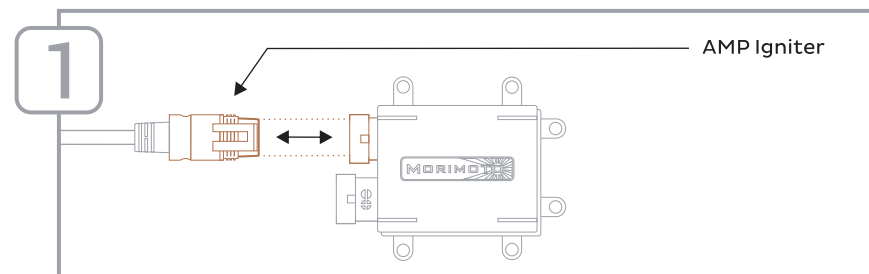

5

Recommended mounting:

Do not mount ballast with connectors aimed upward!

XSB HALO INSTALLATION

12V

12VDC INPUT



DO NOT CUT!



DO NOT GLUE!

1

Using a small flathead screw driver or paper clip, press the tabs holding the halo pins into the connector and remove the wiring from the connector.

2

Test-fit the halo on the shroud to see where it will be mounted.

3

1mm bit

Shroud / bezel

Front

Using a 1mm drill bit, make one hole for each mounting tab, then another hole slightly outside of that for wire to feed up and over the mounting hole.

4

4mm Drill Bit (for wiring)

In the desired location, drill a 4mm hole for the wiring to pass through the shroud/bezel.

5

Shroud / bezel

Front

Feed the wiring through the 4mm hole in the shroud / bezel and re-insert the pins into the connector, ensuring proper orientation of the wire colors.

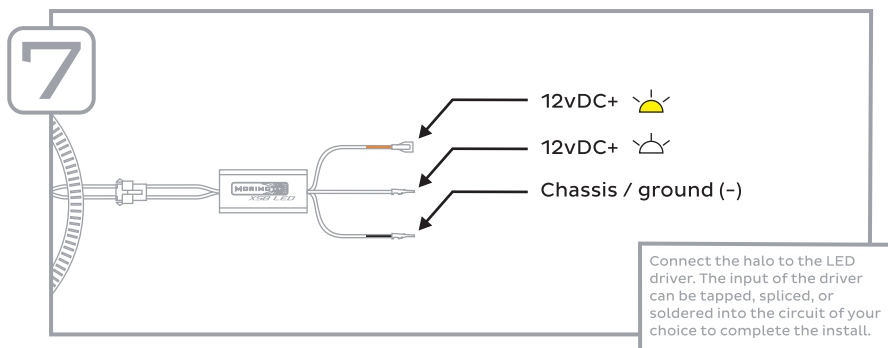
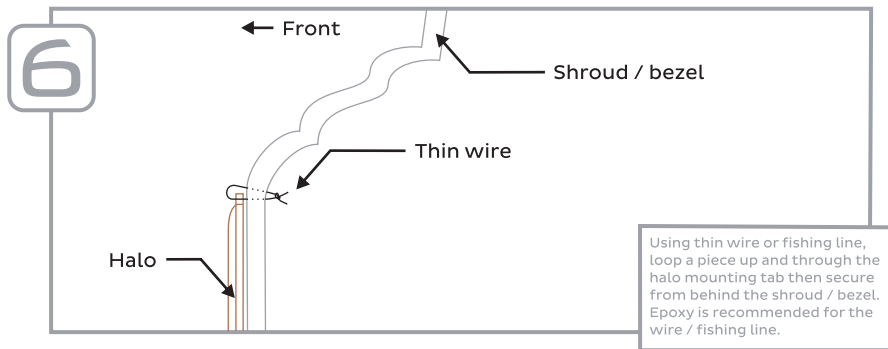

SHROUD INSTALLATION



EPOXY IS RECOMMENDED FOR ALL CONTACT POINTS



E-Z CUT

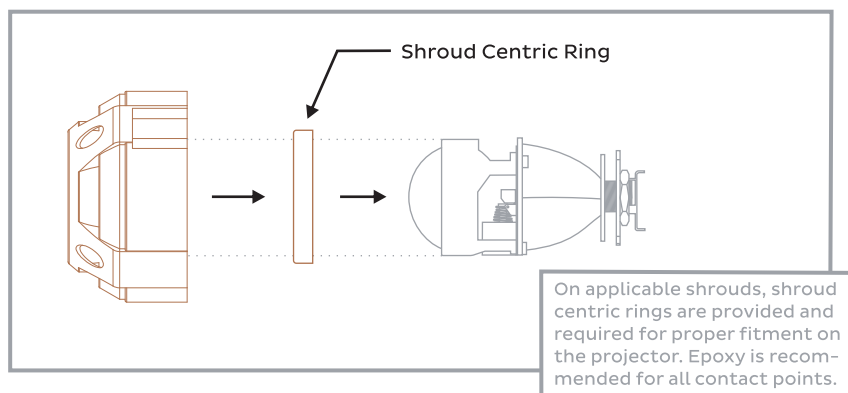

USING RETRORUBBER SEALANT

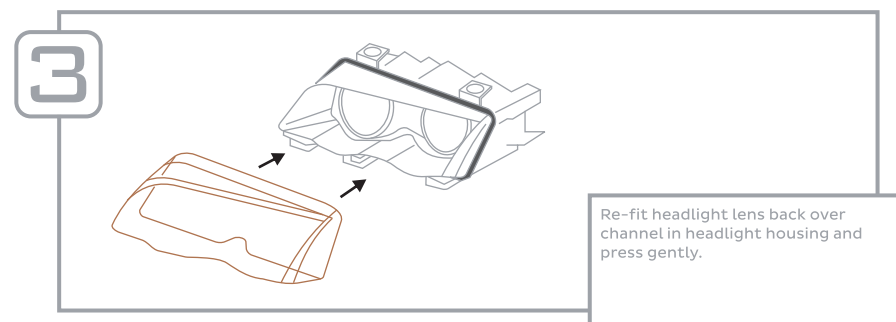
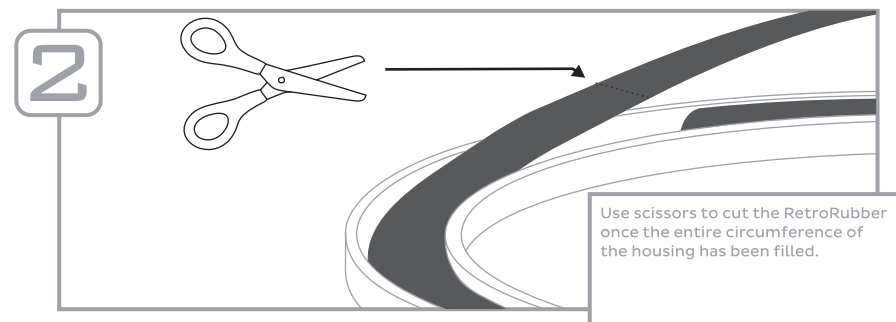
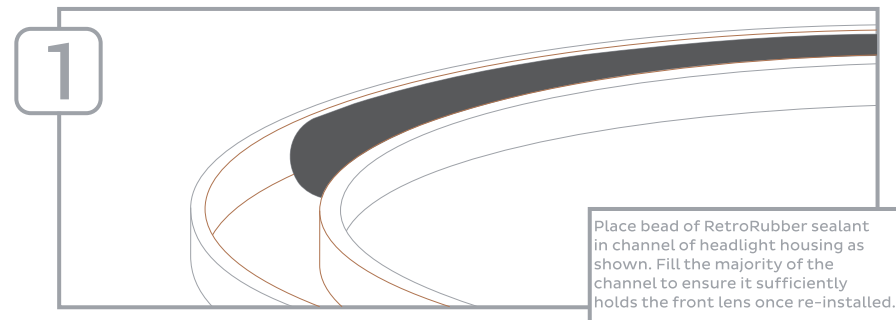

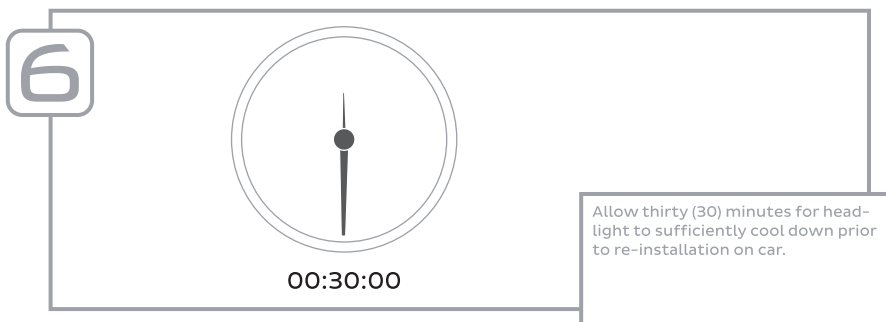
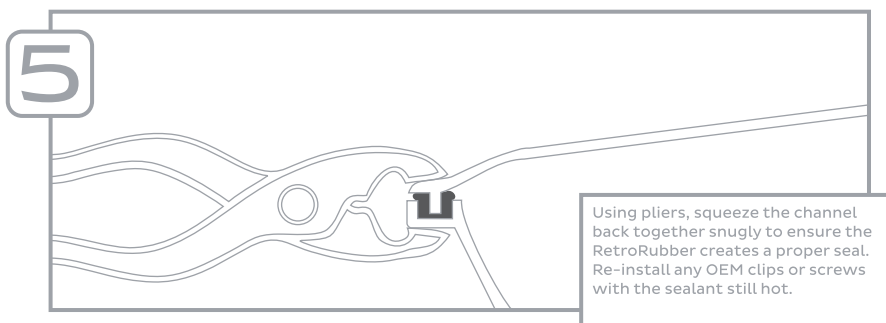
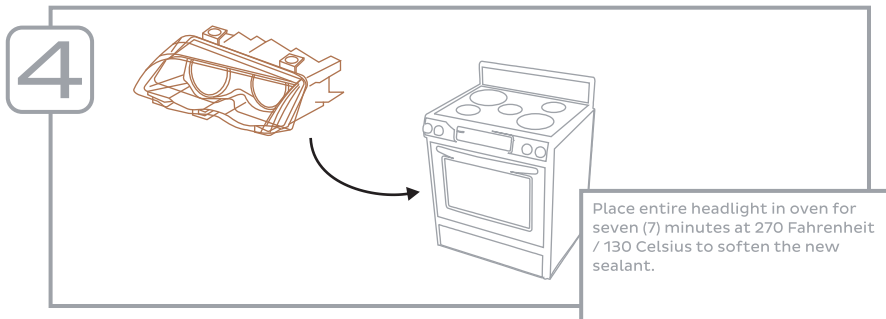

-END-